

System Features >>>

Wireless Transmission

It uses 5GHz communication band. The product has a stronger anti-interference ability. And it can provide greater bandwidth and transmission speed. It is not affected by mobile phones and other Bluetooth devices to ensure the best signal reception.

Secure Encryption System

The product uses 128 bit AES encryption technology. It supports WPA/WPA2 wireless security technology, which prevents eavesdropping and unauthorized access. And it provides a higher level of confidentiality of the conference system.

Powerful Applications

It has wireless and wired conference speech, meeting attendance, voting, custom voting, simultaneous interpretation, video tracking, fire linkage and other meeting functions. And it also has the double backup, network control and other functions. The function is highly centralized, and the system configuration is simple.

Remote Control

Conference controller and computer use TCP/IP protocol, which can be connected to internet through the Ethernet interface and then remotely controlled.

Simultaneous Interpretation Function

With digital audio transmission technology, simultaneous interpretation channel number 63+1, speech separation technology.

Successful Cases >>>

TS-W101/TS-W101A conference units



TS-W-102/TS-W102A conference units



Conference room (square table & round table)



SMART MEETING
MAKE COMMUNICATION EASIER



TS-W100 Series

5G WIFI Conference System

System Features

- Wireless transmission
- Conference management
- Remote control
- Fire alarm linkage
- High privacy technology



System Introduction >>>

The wireless conference system is composed of a wireless controller, a desktop wireless conference unit, an embedded conference unit and a conference unit with electronic nameplate.

It adopts WiFi 5GHz frequency range to transmit and control. The system has these functions including conference speech, meeting attendance, voting, simultaneous interpretation, electronic nameplate, camera tracking, fire linkage and other conference functions.

And it also has optical fiber transmission, dual backup, network management and other functions. It widely is applied to round table meeting room, square desk conference room, multi-function hall, banquet hall, lecture hall and other places.

System Diagram >>>

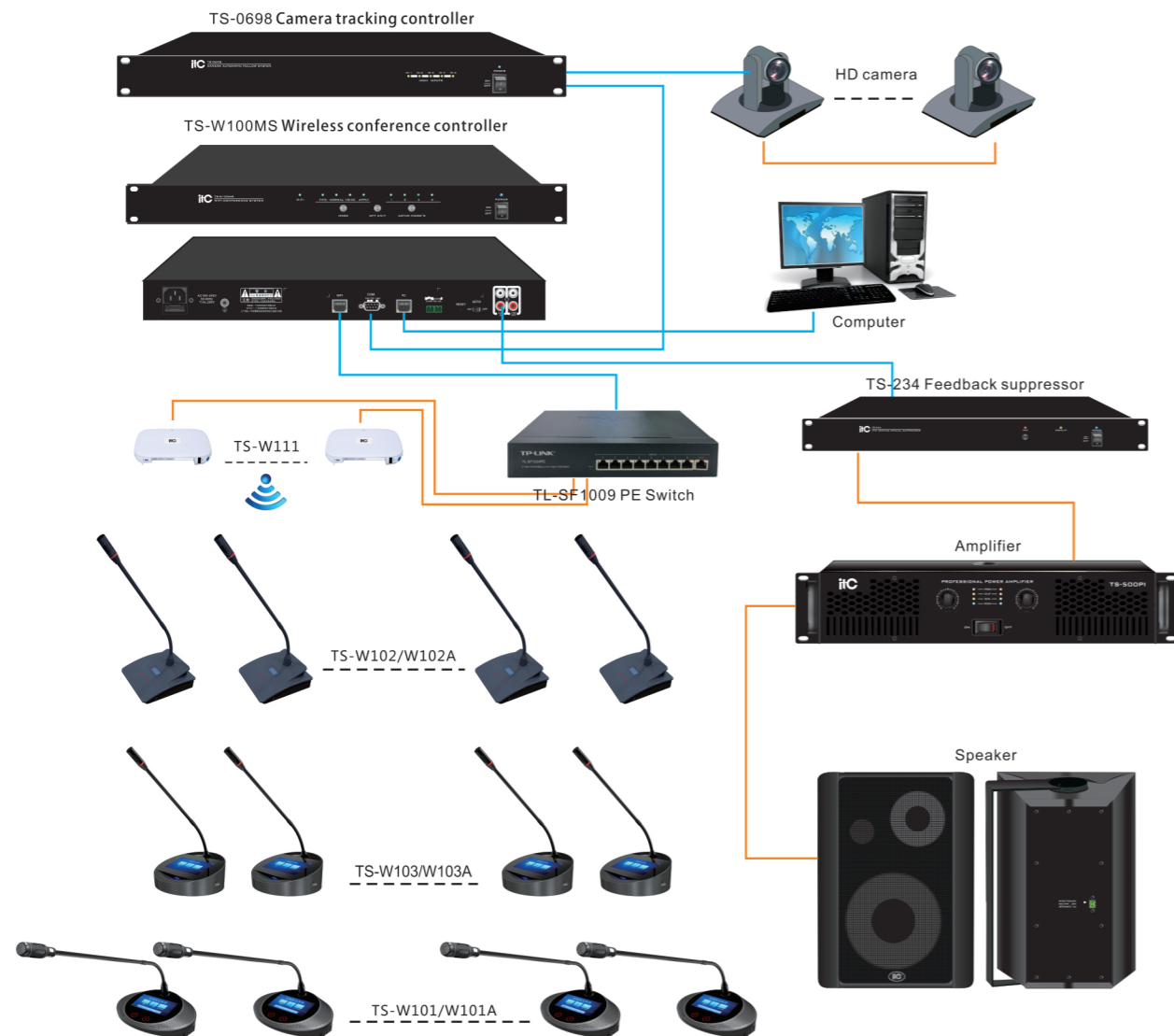

TS-W100
Full Digital WIFI Conference System Controller

- * It adopts 128 AES encryption technology, supporting WPA/WPA2 wireless security technology to avoid any eavesdropping and unauthorized access, providing conference system with higher confidentiality.
- * Four microphone management modes: FIFO/NORMAL/VOICE/APPLY.
- * It has 1 channel RS-485 interface, which supports tracking function by connecting one camera and PELCOD and VISCA control protocols. It can also achieve multi-channel video automatic tracking function with camera tracking controller.
- * It has 1 channel fire alarm linkage trigger interface, which can provide fire alarm information for the conference controller panel touch screen, unit machine screen and PC software under fire emergency.



TS-W111
AP Transmitter

- * Network throughput: it adopts 802.11n and 802.11ac as dual frequency and dual spatial flows technology to provide maximum 1.2Gbps kilo-mega WIFI access, meet the demands of indoor huge capacity and high throughput operation.
- * WIFI security: WIFI AP supports multiple certificated encrypted standards including OPEN, WEP, WPA, WPA2, WPA-PSK, WPA2-PSK, 802.11i, and it provides certifications of MAC, WEB, 802.1x, fishing AP testing, WIFI user isolation and security feature of WIFI user blacklist and white list. It helps provide a safe network environment to the user.



Chairman Unit TS-W101
Delegate Unit TS-W101A

- * Microphone with 48KHz sampling rate is with the better sound quality than CD's, which is clear and bright. With DSP audio processing inside, no "puff" low-frequency impact.
- * With speaking time setting and timing speaking function.
- * The chairman has a priority function and turn off all delegate microphones that are speaking. The representative can make an application and Chairman unit has approval right.
- * With 5 EQ adjustment function (PC software input password is adjustable), the different sound effects can be adjusted according to speaker's voice characteristics for a perfect effect.



Wireless Chairman Unit TS-W102
Wireless Delegate Unit TS-W102A

- * The microphone uses 48KHz sampling rate, higher than the CD's sound quality, clear and bright. With internal DSP audio processing, "pop" low frequency impact sound won't appear.
- * Using advanced processing chip architecture, and unique processing algorithms, microphone boot connection time is only 5 seconds.
- * With the function of intelligent detection of faults, it prompts the user for AP failure, host communication failure, signal is too weak etc.
- * Supporting simple USB setting SSID, password function, ensure that the system will not connect to the wrong AP.

Related Products

